

How to connect to Wi-Fi using an iPhone or iPad

helpdesk@nmit.ac.nz - 2025-06-06 - Connecting to WiFi

Connect to Wi-Fi using an iPhone or iPad

(Your device must have a passcode set to be able to access the Wi-Fi at NMIT)

1. Open **Settings** > **Wi-Fi** and connect your iPhone or iPad to the **NMIT-Wireless**

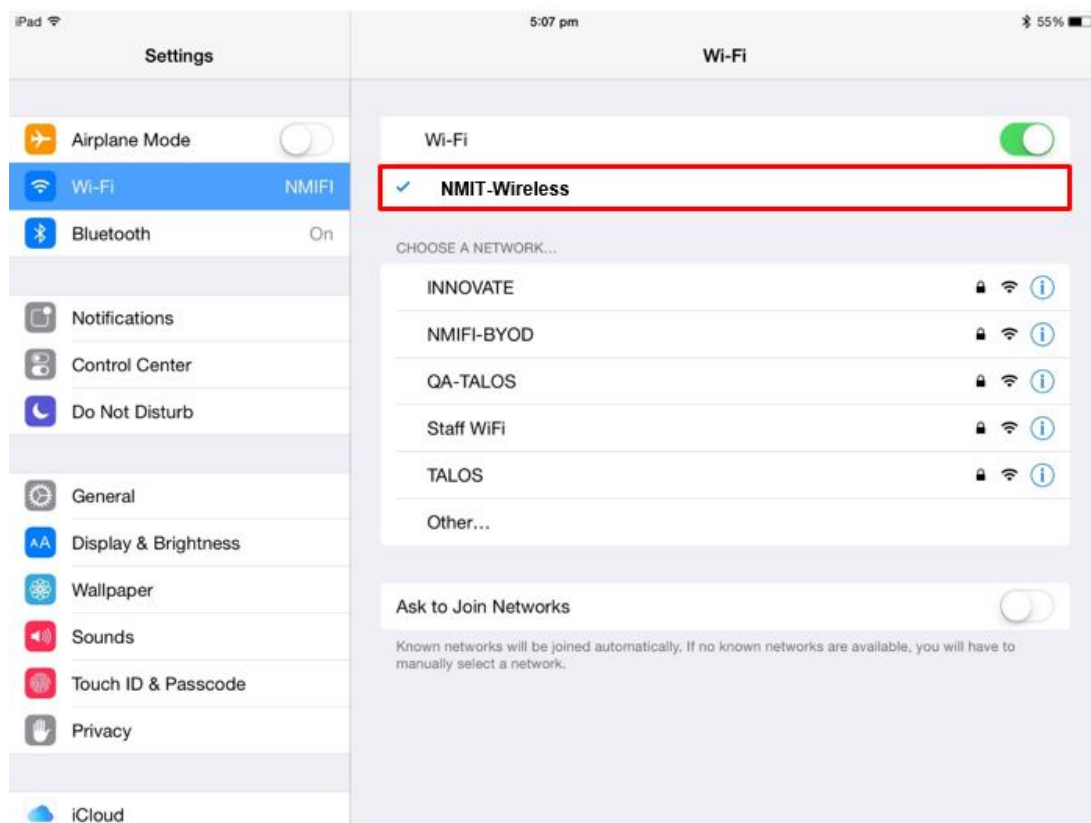

2. Open Safari (or other browser) and browse to [nmit.ac.nz](https://pcloudpath01.nmit.ac.nz), this will redirect you to <https://pcloudpath01.nmit.ac.nz>. Read the terms and conditions and if you agree with them check the box and click on **Start**

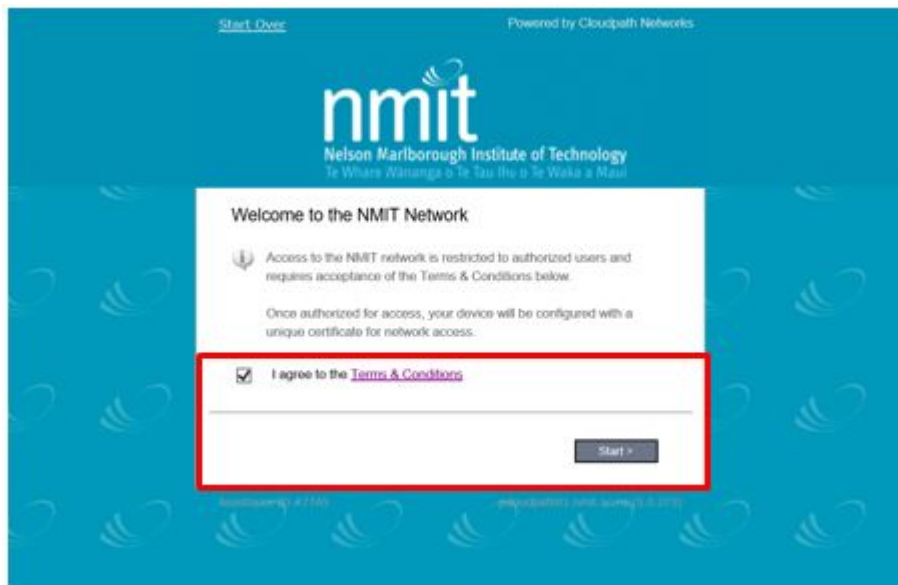

3. Select the appropriate registration for you.

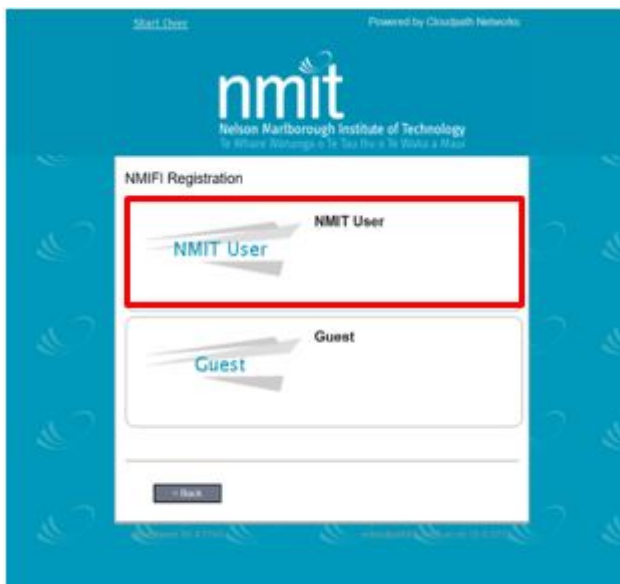

4. If you have a user account, choose the **NMIT User** option and provide your NMIT Username (**Student first-lastname**, **Staff first.lastname**) and Password. Click **Continue**.

[Start Over](#) Powered by Cloudpath Networks

nmit

Nelson Marlborough Institute of Technology
Te Whare Wānanga o Te Tau Ihu o Te Waka a Maui

Your username and password are required to access the network.

Username: Firstname-lastname

Password: [Masked Password]

< Back Continue >

Assistance ID #77A5 pcloudpath01 nmit.ac.nz (3.0.373)

5. If you have correctly entered your username and password you will be asked to install a profile that will allow your device to connect to the Wi-Fi. Click on **Install**.

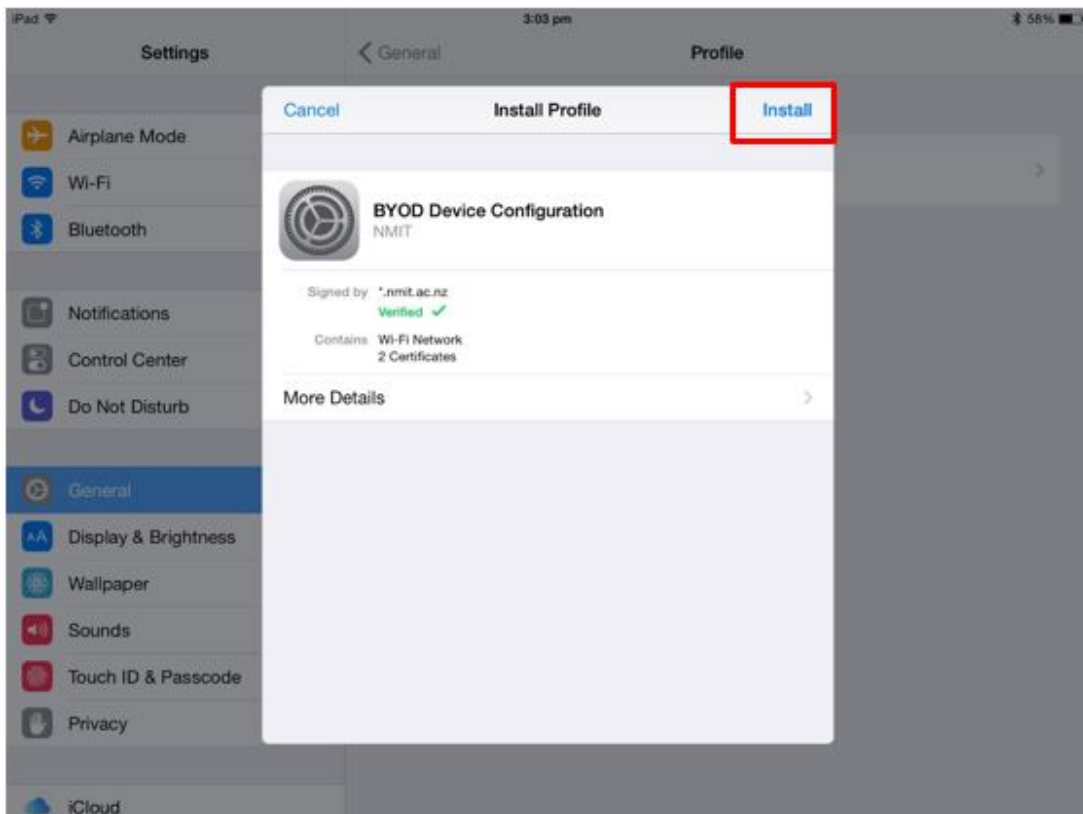

6. Select **Install** again to confirm the profile is to be installed.

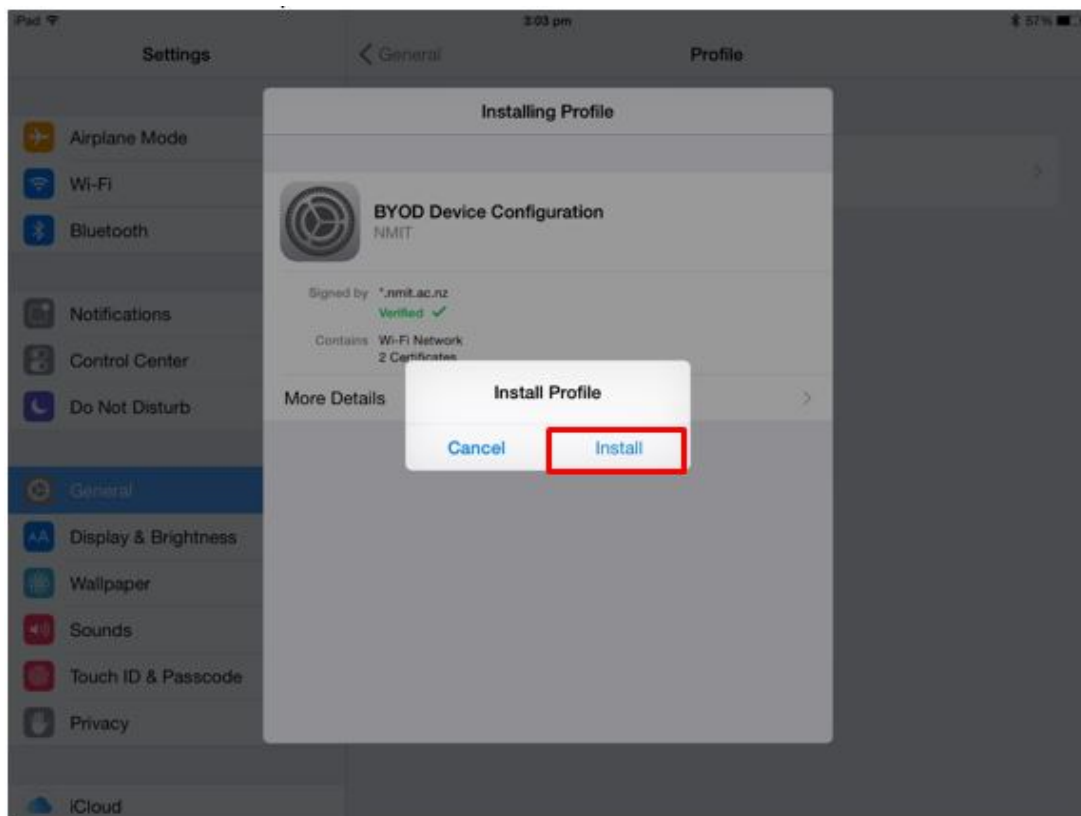

7. Enter the Passcode of your device to enable the profile to be installed.

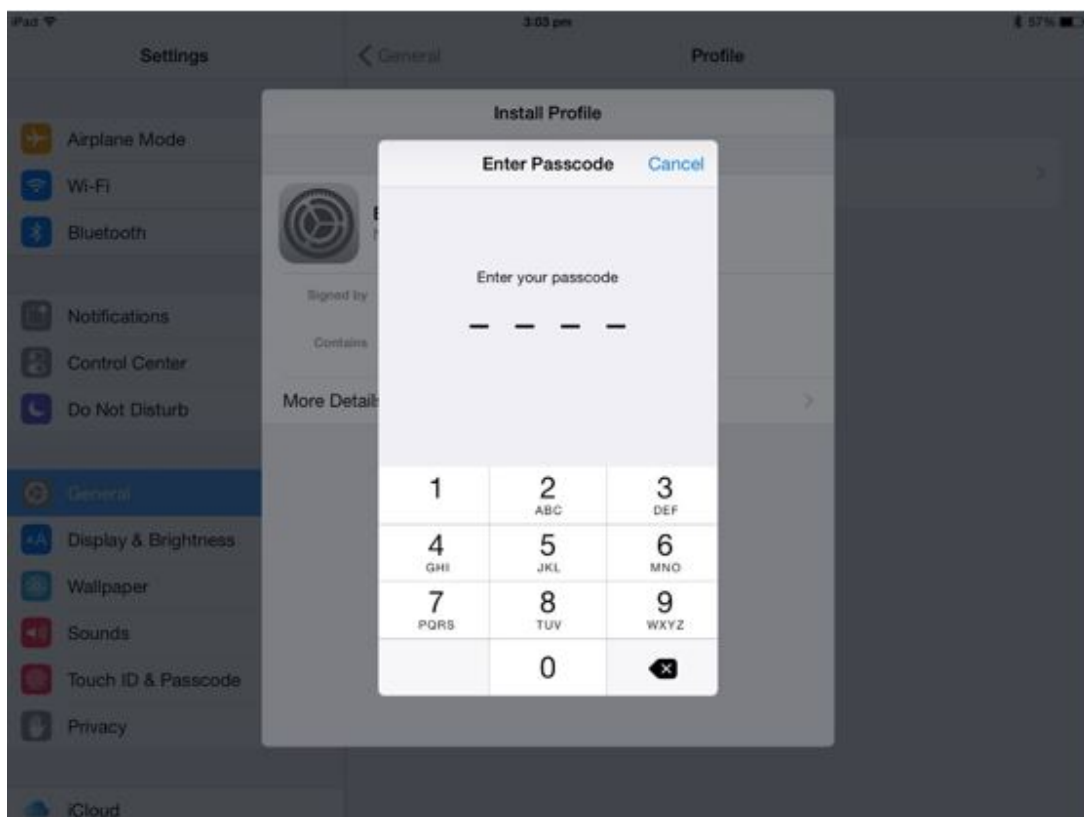

8. Once the profile is installed select **Done** to complete this process.

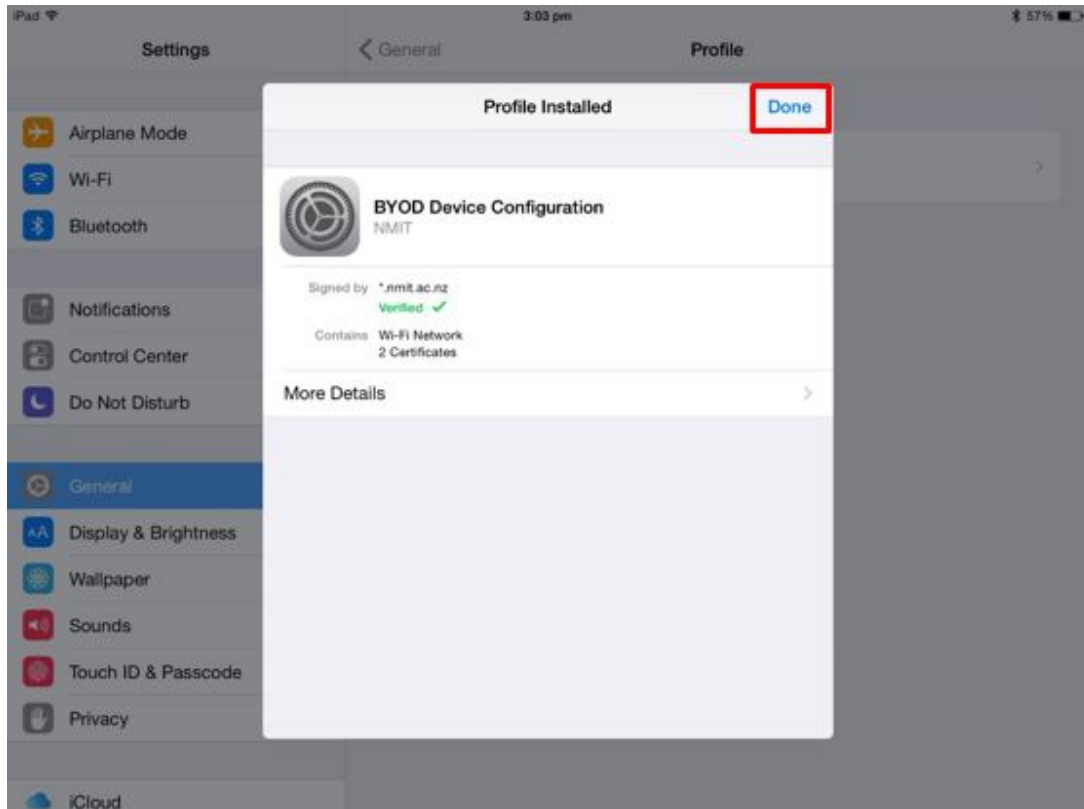

9. Go into **Settings > Wi-Fi** on your device and select the **NMIT-BYOD** network.

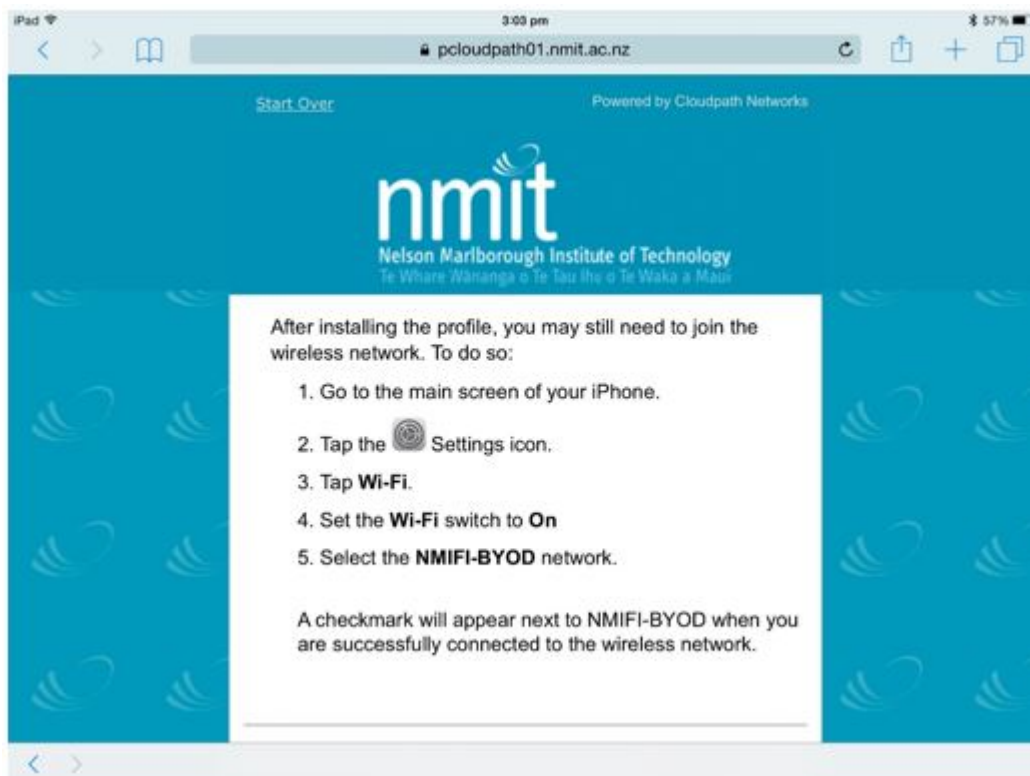

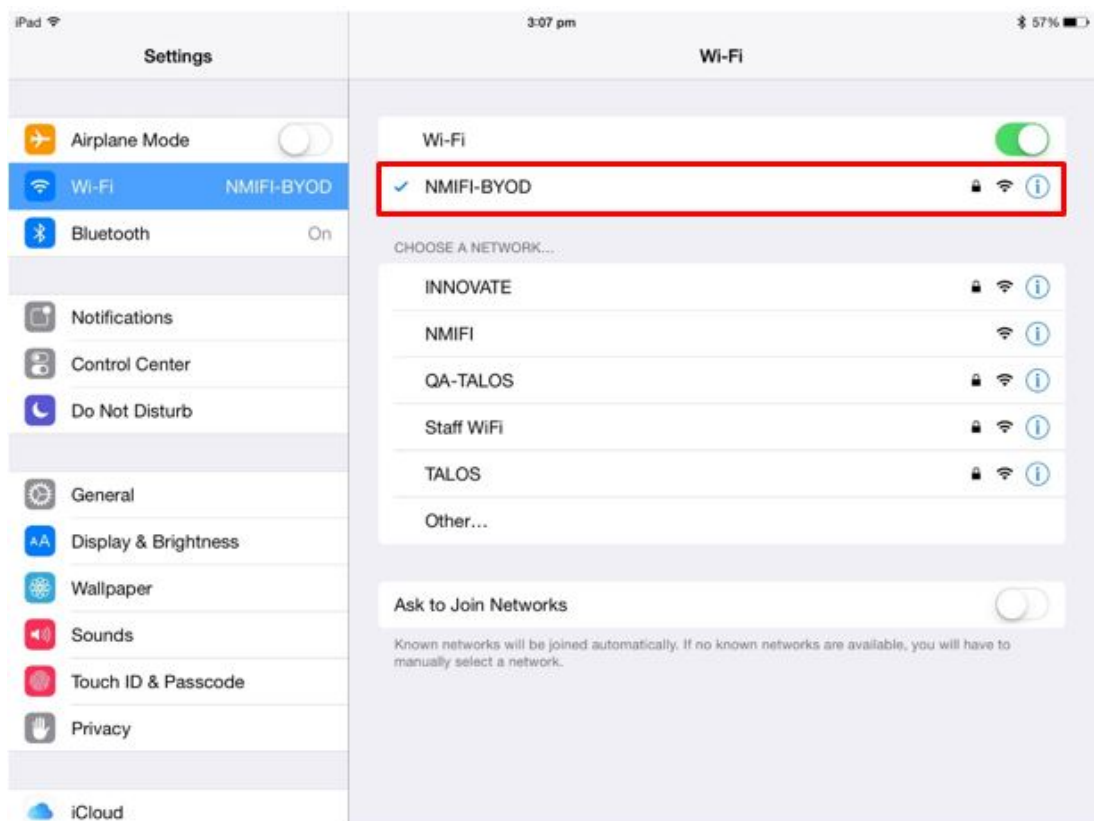

You are now connected and can browse the Internet